



2024 INSTALLATION MANUAL

Tradesman 2000



TABLE OF CONTENTS

PREPARE FOR INSTALLATION -----	1
INSTALLATION SAFTEY -----	2
PARTS LIST -----	3
INSTALLATION FORD, DODGE, CHEVY, TOYOTA-----	4-9
CONNECTING ELECTRICAL CABLES -----	10
CONNECTING HYD LINES-----	11
FINISH FRAME CONSTRUCTION / CHECK REMOTE AND HYDRAULIC FLUID-----	12
VIBRATION BRACKET INSTALATION -----	13
SCHEMATICS -----	14-15
INSTALATION HELP SHEET -----	16

INSTALLATION INSTRUCTIONS

PREPARE FOR INSTALLATION

Completely empty the truck bed. Once empty it is recommended that the bed be power washed prior to installation.

Bed Liners Spray-in bed liners provide an acceptable mounting surface for Impac lift installations. **However, hard plastic drop-in bed liners must be removed from the truck bed in order to provide a solid mounting suitable for installing IMPAC-Lift.**

⚠ CAUTION **It Takes Two.** Several steps in the installation require the help of another person, for example placing components properly, or attaching backing plates under the bed. **Identify all components** supplied in the installation kit and match them with the parts list. If any components are missing, contact **Impac-Lift Tech Support** at www.IMPACMFG.com. Click on **Contact Us** button or call 1-956-233-3294 before beginning installation.

⚠ WARNING **Park the truck on a level surface, set the parking brake and chock the wheels for safety.**

Tools Needed

Drill	5/16" Drill Bit {Not Included}
Tape Measure	Drill Bit Set
Ratchet	1 1/4" Metal Hole Saw Bit {Not Included}
#2 Phillips Drill Bit	Saw
Standard Deep Socket Set	5 Foot 2 x 4 Lumber
Standard Hex Socket Set	Rubber Mallet
Open End Wrench Set	

Read the instructions completely before installation. It is recommended not to skip steps. We have carefully considered the order of each step to ensure the best possible installation with the fewest possible problems.



Prior to installation, park the truck on a level surface, set the parking brake and chock the wheels for safety.

Tradesman 2000

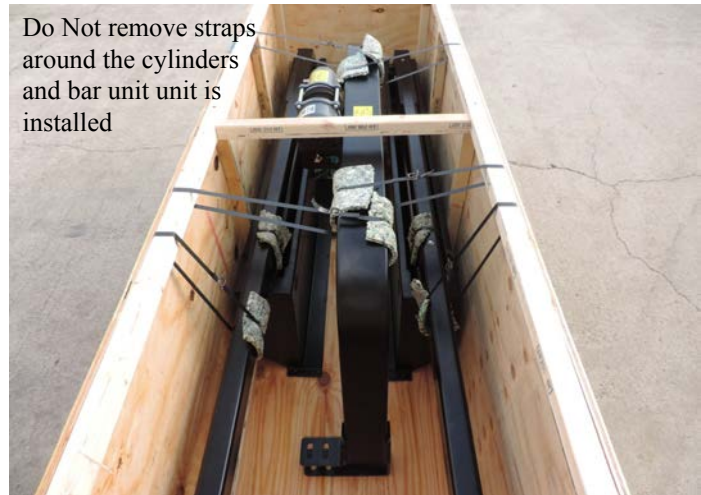

IMPAC 2000 STANDARD



Before beginning the installation remove the packing material to expose the Impac Lift on the pallet. **LEAVE BOTH FRAMES SECURED TO THE PALLET.** Carefully inventory the items identified in the illustration above. Check the items in the hardware package against the list on page 3 of this manual. If any items are missing contact **Impac Lift tech support at www.IMPACMFG.com. Click on Contact Us button or call 1-956-233-3294.**

IMPAC 2000 TRADESMAN INSTALLATION HARDWARE

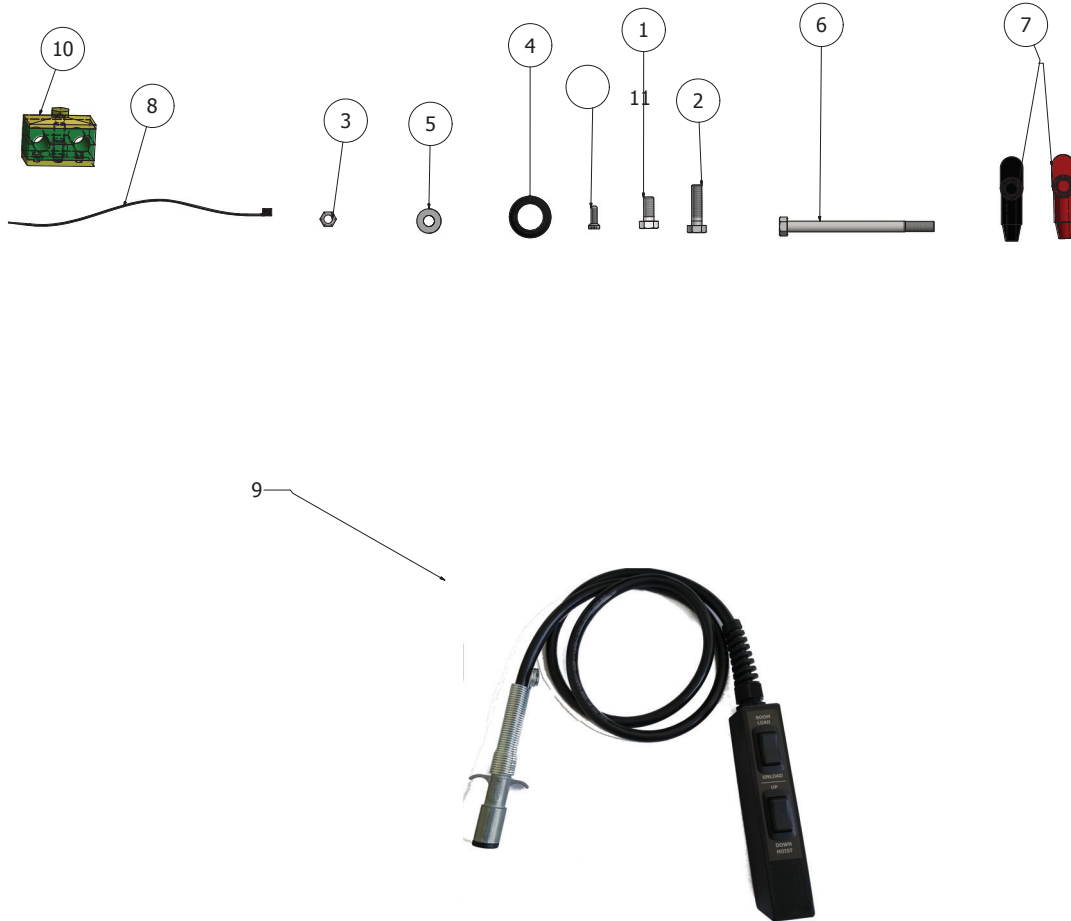

PARTS LIST			
ITEM	QTY	PART NUMBER	DESCRIPTION
1	4	IMP735	BOLT HEX 5/16"-18X3/4" SS
2	16	IMP649	HEX BOLT 5/16"-18 X 1-1/4 SS
3	16	IMP498	NUT, NYLOCK 5/16"-18 SS
4	2	IMP882	GROMMET RUBBER 1-1/2" X 1-1/8"
5	32	IMP579	5/16 SS WASHER
6	4	IMP806	5/16 X 4" BOLT
7	1	IMP596	BOOT, BATTERY RED&BLACK SET
8	8	IMP578	CABLE STRAP 8"
9	1	IMP2211	CONTROLLER 5'
10	4	IMP1057	TWIN HOSE CLAMP
11	11	IMP1100	TWIN HOSE BRACKET SCREWS

**** #6 BOLT 5/16 X 4" IS PROVIDED IF NEEDED FOR FASTENING UNIT TO TRUCK BED****

2023 lift units do not required Foot bracket. Mounting holes are now inside box.

Installation Ford, Dodge, Chevy & Toyota Section

(2022 and older)

This section applies to the Boom Arm Frame installation on Ford, Dodge, Chevy and Toyota trucks only.

Foot Plate Position for Chevy

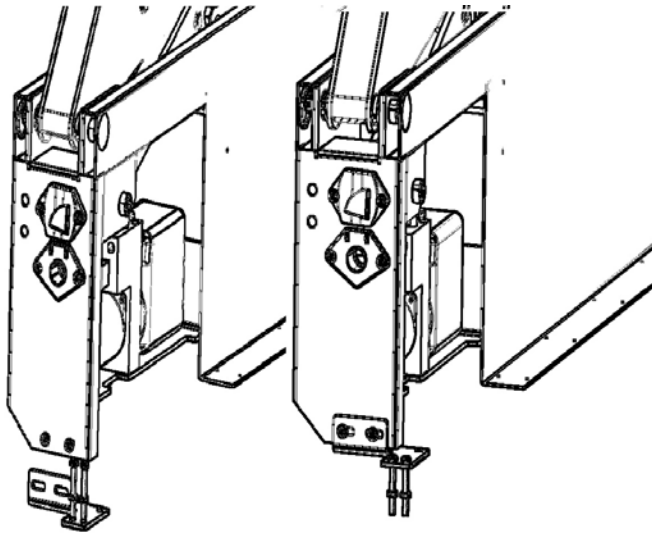

Step 1

Foot Plate Position for All Models Except Chevy

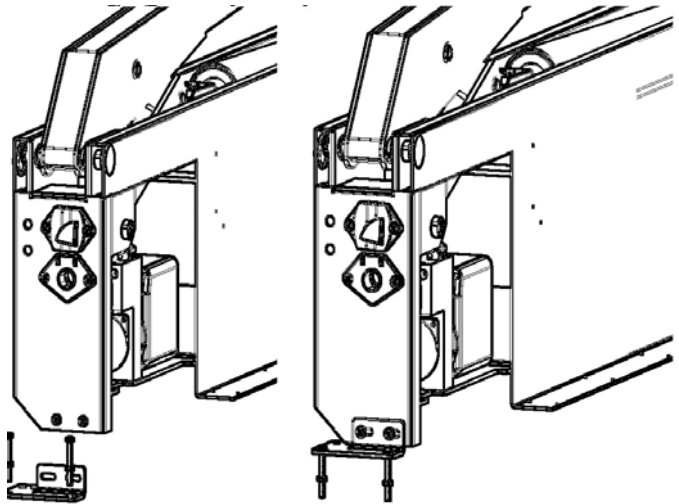

Step 1

Step 1— Attach the front brackets to units. REF-1 (IMP2024P) & REF-2 (IMP2025P)

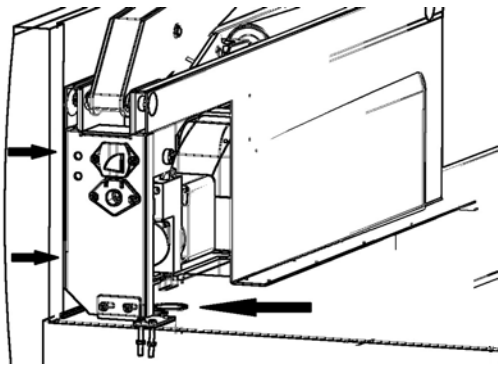

Fig. A

Step 2—Take the unit frame that has the hydraulic pump and place it on the drivers side of the pick up truck bed with the arm end pointing forward toward the truck cab. Take the remaining unit frame and place it on the truck bed on the passenger side. Passenger side has the ALUMINUM HYD LINE attached (REF page 11) and connect to driver hyd hoses.

Note— Depending on whether or not the truck bed has a bed liner or not, it may be necessary to use the bed spacers provided to make the unit level (use where ever necessary) REF-4 (IMP2202) and REF-5 (IMP2203).

Step 3— Align the edge of both units with the end of the truck bed post (As Shown in Fig A&B). Once both units are in position, on the driver's side (pump side) mark a center for a 1 5/8" hole for the hydraulic hoses just under the pump plate notch so that the hoses will drop straight down from the pump, through the truck bed floor.

REPEAT for opposite side.

Step 4— Pull units back and drill the 1 1/4" hole that was marked in the previous step. Insert the rubber grommets REF 19 (IMP780).

Step 5— With the units pulled to one side feed the power and ground cables. (FIG C)

Fig. C

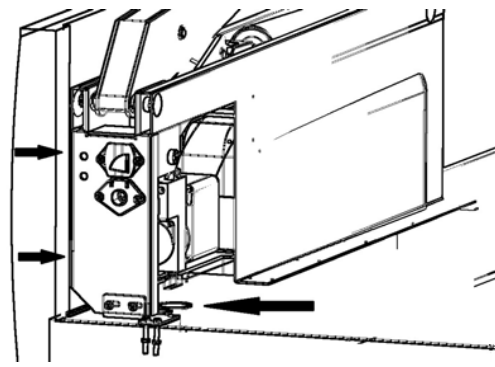
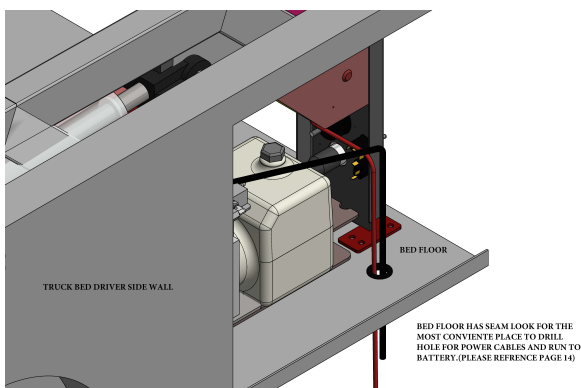

Fig. B

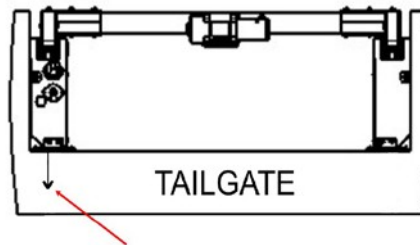

Fig D

Step 6— With the units pulled back feed RED Electrical cable through the rubber grommet on the Driver Side. (As Shown in Fig D)

MOUNT THE WINCH CROSSBAR

Step 7— On the Driver Side run the electrical wires from the boom arm through the cross bar and out the hole located near the winch. Insert the crossbar on both arm brackets. The crossbar fit into the bracket maybe extremely tight. It may be necessary to tap it in place with the rubber mallet.

Step 8— Secure the crossbar to the unit arm brackets with the 5/16" x 4" bolts REF-22 (IMP806), flat washers REF-13 (IMP579) (on top and bottom) and the 5/16" nylon lock nuts REF-8 (IMP498). (Do not tighten until unit is squared) (As Shown in Fig. E)

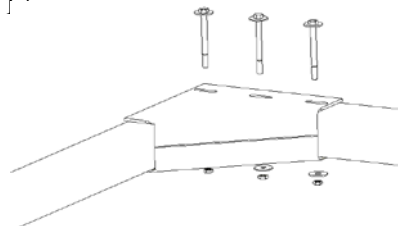

Fig. E

Step 9— Connect the wires to the appropriate terminals on the winch. (As Shown in Fig F)

Fig. F



Squaring the Unit to Bed

Step 10— Align the edge of both units with the end of the truck bed post. (As shown in Fig G)

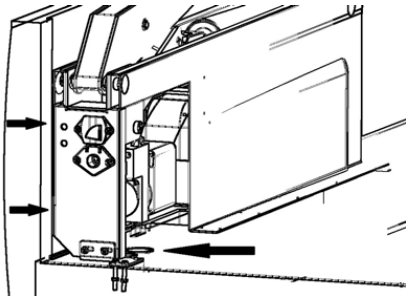

Fig. G

Note— Depending on whether or not the truck bed has a bed liner or not, it may be necessary to use the bed spacers provided to make the unit level (use where ever necessary)
REF-4 (IMP2202) and REF-5 (IMP2203).

Step 11— Cut 2x4's to the measurement acquired in the previous step (distance between the units) to help brace the units and keep them square. (As shown in Fig H)

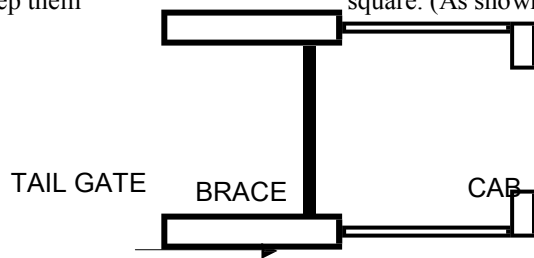

Fig. H

Note— Be sure to maintain the same distance between units from front to back, as well as from the edge of the truck bed. (As shown in Fig I)

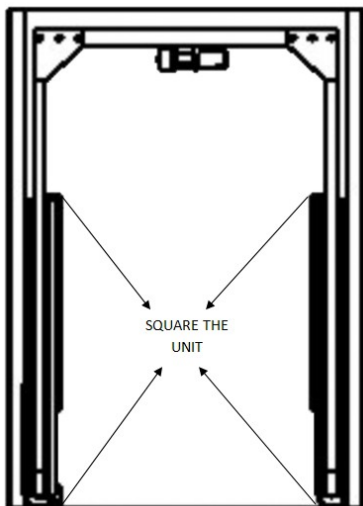

Fig. I

Securing unit to truck bed

Step 12— Align the 5/16" drill bit through the holes in the front foot bracket and drill through the truck bed floor. Run the screw 5/16"-18L x 1.25 S.S. REF-16 (IMP649) with washer REF-13 5/16" S.S. (IMP579) through the holes and put a washer REF-13 5/16" S.S. (IMP579) and nut REF -8 5/16"-18 (IMP498) on from the underside, hand tighten only. (As Shown in Fig. J)



Fig. J

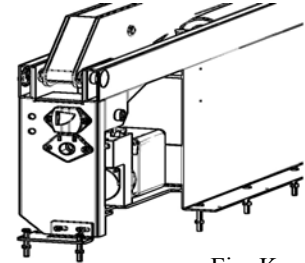

Fig. K

Step 13— After placing the foot bracket loosely, drill the pilot holes along the side of the unit {Depending on your model drill through pilot holes that don't interfere with the bed seam.} After you have drilled the holes begin placing the screws 5/16"-18L x 1.25 S.S. REF -16 (IMP649) with washer REF -13 5/16" S.S. (IMP579) through the holes and put a washer REF- 13 5/16"s (IMP579) and nut REF -8 5/16"-18 (IMP498) on from the under side starting from the back of the unit and working to- wards the front ensuring that the unit stays square. (As Shown in Fig. K & I.)

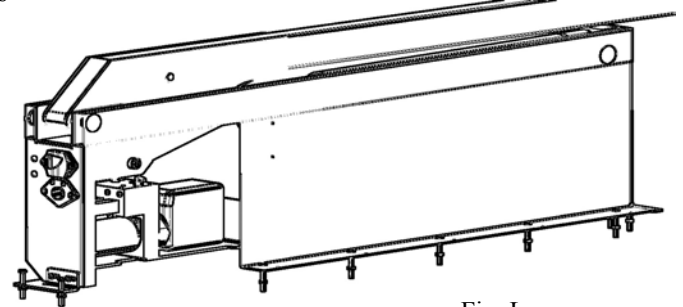

Fig. L

Step 14— Then go back and tighten the screws on the front foot bracket. **Repeat process on the other side.**

Step 15— After the unit is tighten, go back and tighten the screws on the crossbar / loop. (As Shown in Fig. M)

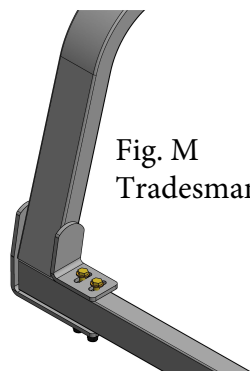

Fig. M
Tradesman

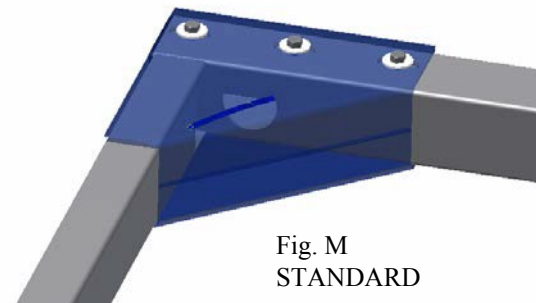
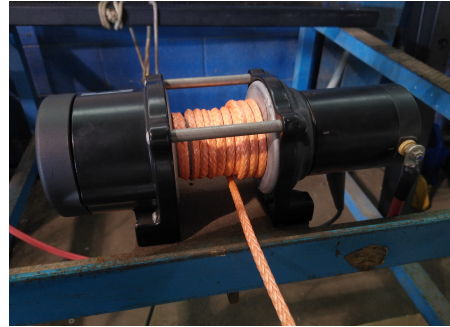
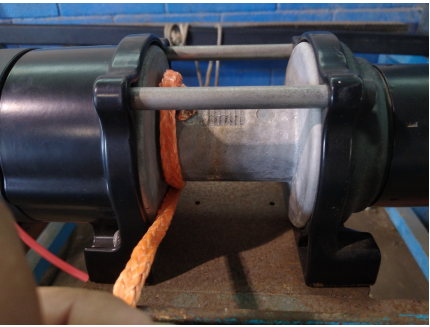
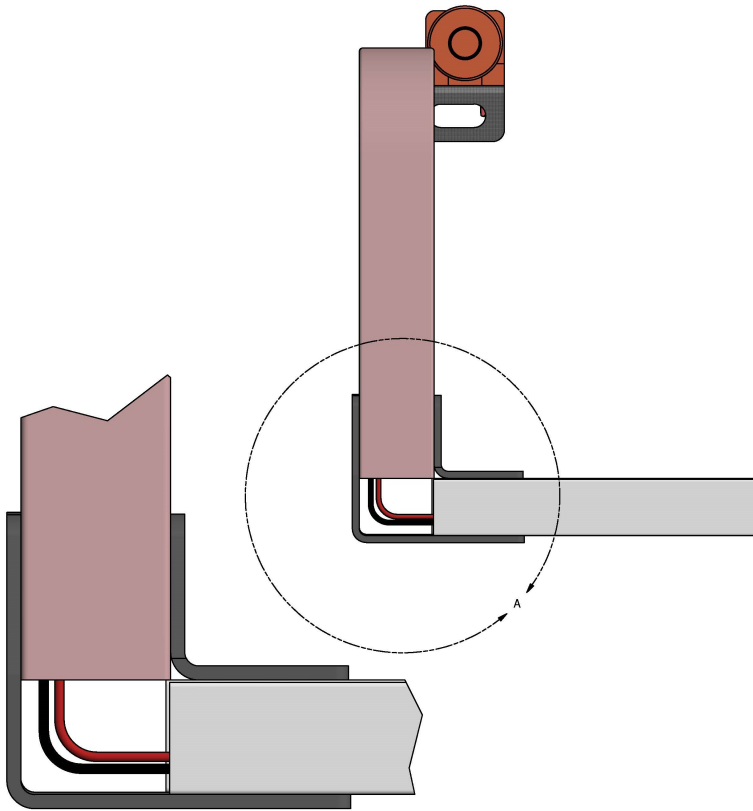

Fig. M
STANDARD

IMPAC 2000 TRADESMAN Rope Placement



IMPAC Tradesman 2000 Bar Installation



Insert the hoist cables through the bottom of the boom up to the winch.

Insert boom into arms carefully without damaging hoist cables.

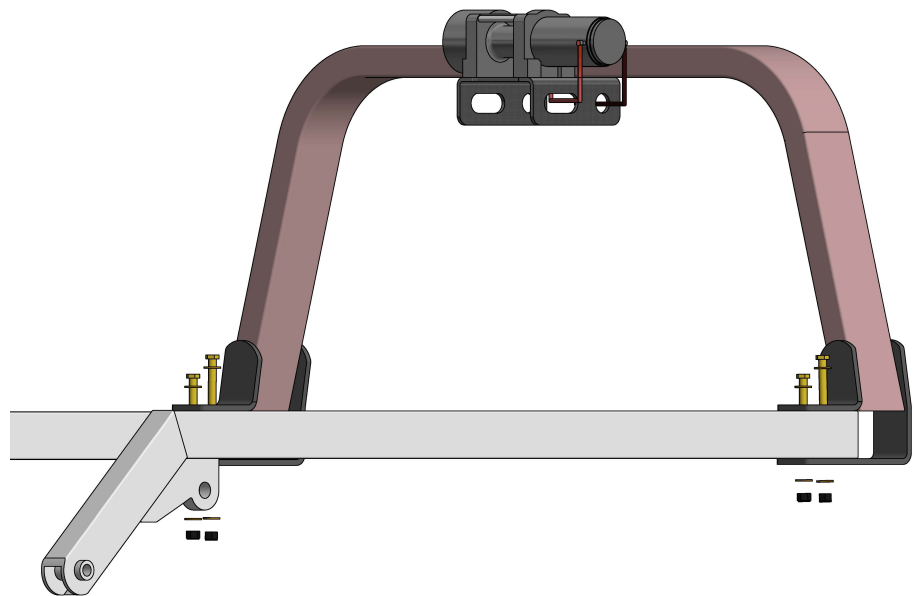

Insert 4 1/5" bolts.
(**BE CAREFUL ON DRIVER SIDE NOT TO DAMAGE HOIST CABLES**) and tighten down

TRADESMAN 2000 CROSS BAR MOUNTING

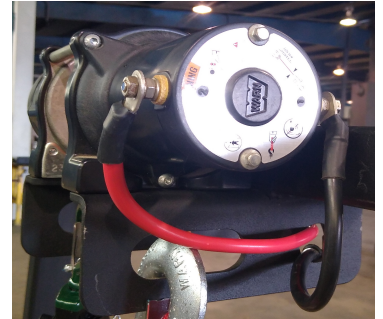

Connecting the Electrical Cables

VERY IMPORTANT

Disconnect the Fuse Box off the Long Red Cable. Run the Long Red and Black Cable under the truck bed and attach it to the chassis with the supplied tie wraps. Pass the ends up into the engine compartment and reconnect Long Red Cable to the Fuse Terminal.

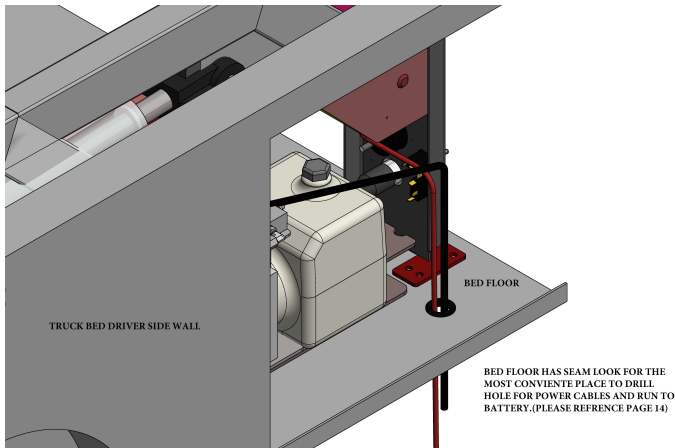

Mount the Fuse Box in a clear area of the truck's engine compartment firewall. Connect the Short Red Cable to the fuse box and positive post on the battery.

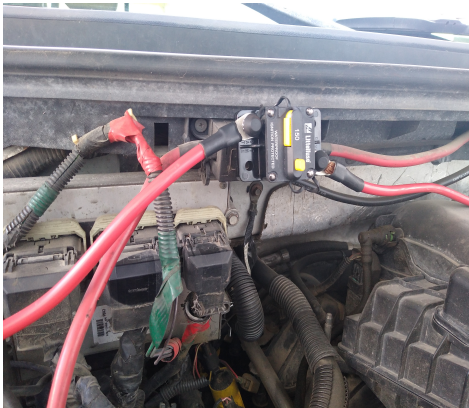

Connect the Black Cable to the negative post on the battery and mount the cable in a clear area away of the truck's engine. please Ref to page 14

CONNECTING AND SECURING HYDRAULIC LINES

STEP 1

WITH THE PROVIDED SCREWS (IMP1100) SECURE THE HYD LINE TO THE BED BULK HEAD WALL.

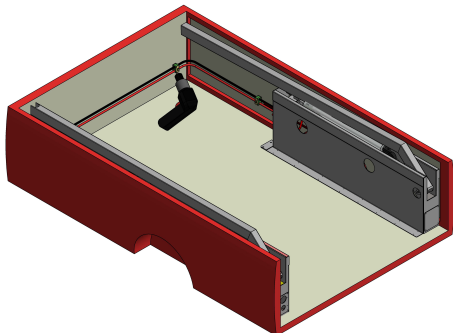

STEP 2 **

CONNECT THE DRIVER SIDE RUBBER HOSE LINES TO THE HYD LINE ACCORDANLY BY COLOR RED TOP LIKE IN (FIG A) ALSO REFERENCE PAGE 15

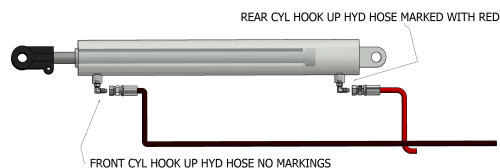

*SHOWING PASSANGER SIDE AS HOSES ON DRIVER SIDE WILL COME CONNECTED

****CAUTION WHEN REMOVING PLUGS AND CAPS TO CONNECT THE HYD HOSES OIL MAY LEAK A LITTLE SO MAKE SURE TO HAVE A SMALL CONTAINER OR RAGS AVAILABLE.**

STEP 3

USE SCREWS PROVIDED TO SECURE HYD HOSE TWIN MOUNTING BASE TO SIDE OF BED WALL. MAKE A PILOT HOLE FOR SCREW #10 (.1900). FOUR PCS WILL BE INCLUDED YOU WILL INSTALL 2 PER SIDE.

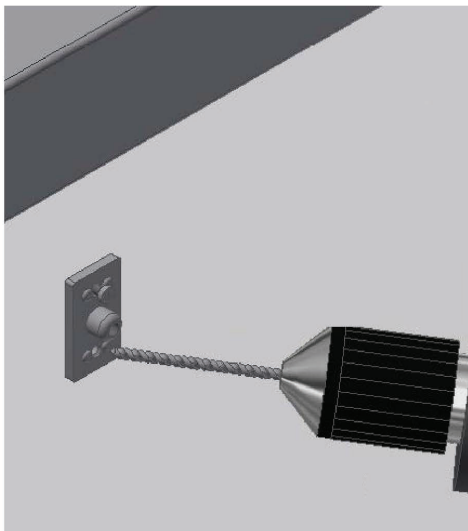

STEP 4

NOW WITH THE PROVIDED #10 SCREWS TIGHTEN BASE TO BED WALL. REPEAT FOR THE REST OF THE MOUNTING BASES

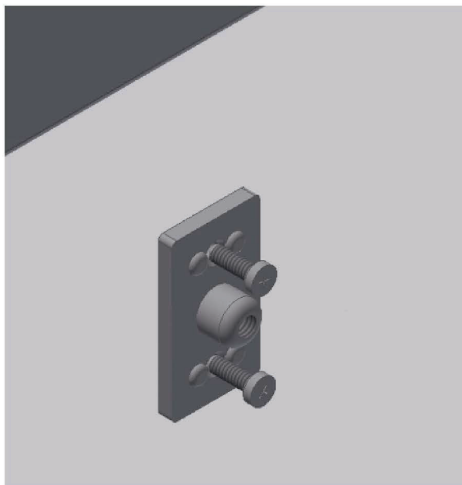

STEP 5

NOW PLACE THE HYD HOSES THUR THE GREEN SUPPORT BRACKETS. NOW ASSEMBLE THE OTHER HALVE AND TOP COVER AND TIGHTEN.

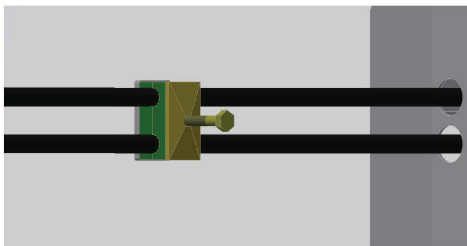

Finish Frame Construction



It will probably be necessary to tap in the cross bar end caps with the rubber mallet.



Finally, cut the shipping straps band off the arms. Before operating.

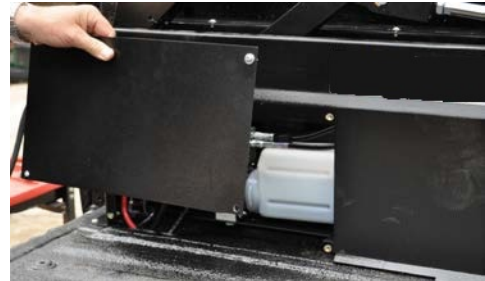

Attach the Side Access Panels to both sides of the Unit Arm Frames.

Check the Remote Control and the Hydraulic Fluid in the Lift Pump

Plug the female fitting into the receptacle on the rear of the pump side frame. Depress and hold the “Boom Out”

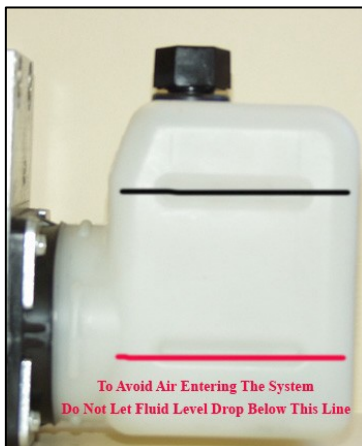

As the arms come out, the hydraulic fluid level in the pump reservoir will drop towards the bottom indentation in the reservoir (indicated by the red line in the illustration). Do NOT allow the fluid to go below the bottom indentation which may lead to air entering the system. Add transmission fluid as needed to keep just above the bottom line. (Do NOT over fill). Once boom fully extended, return boom to rest position and top off fluid to top line if needed.

IMPAC VIBRATION BRACKET 2022

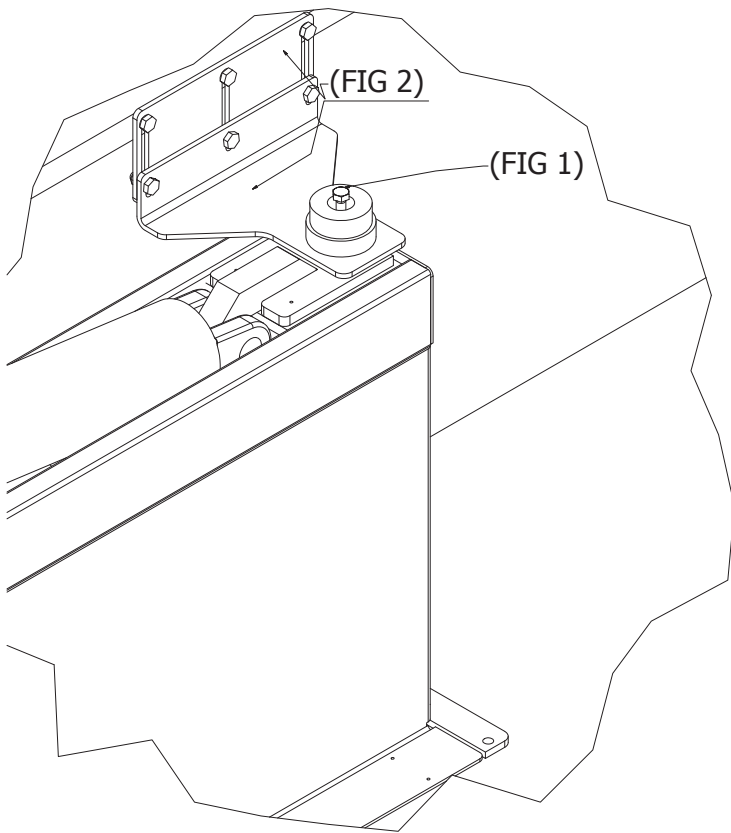

(FIG 2)

USE PROVIDED VIBRATION BARCKET FOR BED HEIGHT OF 20.1"
USE THE EXTENDER FOR BED HEIGHT TALLER THAN 20.1" UP TO 22.4"

- Step 1 - Loosen lower bumper pad bolt. (FIG. 1)
- Step 2 - Align bracket with bed rail. Mark and Drill. (FIG.2)
- Step 3 - Install bolts tight to bed rail, then tighten lower bumper pad

This bracket is used for damping rough road vibration to prevent lower bed cracking around mount bolts. Fasten with three bolts provided to truck-bed side wall.

IMPAC 2000 ELECTRICAL

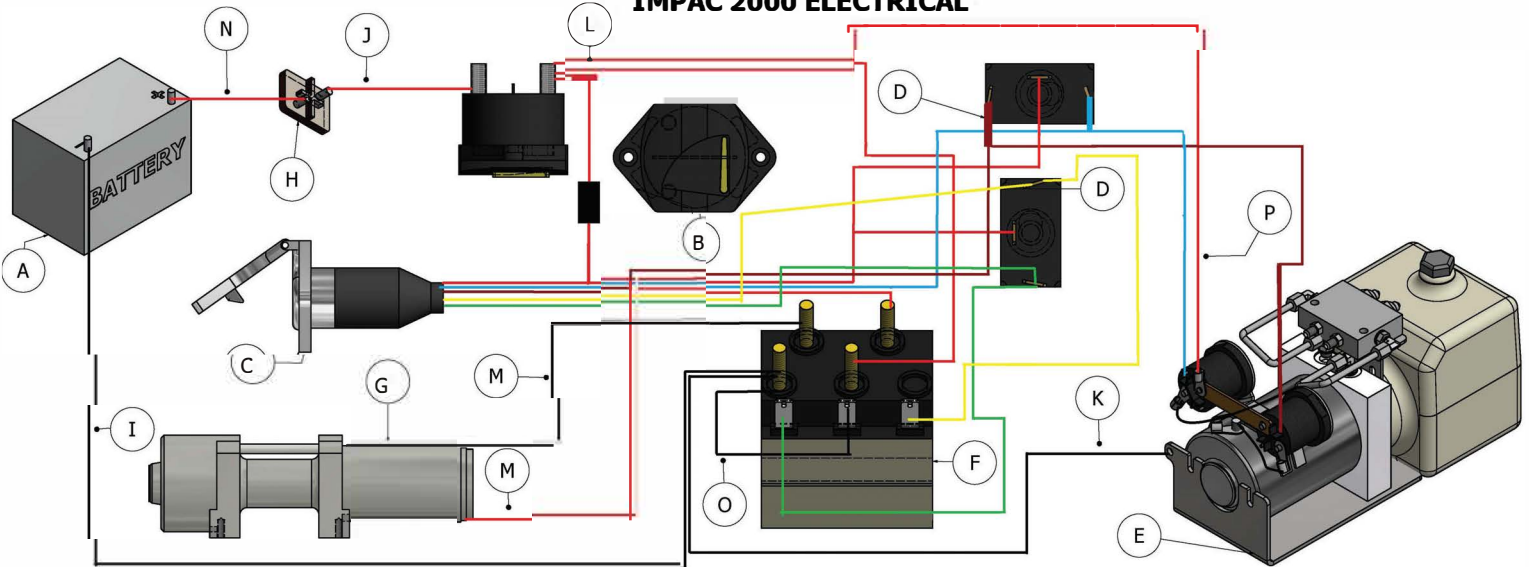

PARTS LIST

ITEM	QTY	PART NUMBER	DESCRIPTION
A	1	*NOT INCLUDED*	TRUCK BATTERY(NOT INCLUDED)
B	1	IMP508	CIRCUIT BREAKER 150 AMP
C	1	WG139	CONTROLLER PLUG IN 25"
D	2	IMP969	TOGGLLE SWITCH
E	1	IMP2095	PUMP ASSEMBLY
F	1	IMP878	WARN SOLENOID
G	1	IMP865	WARN WINCH
H	1	IMP655	150 AMP FUSE
I	1	WG142	4GA. 360" BLACK CABLE (SOLENIOD TO GROUND ON BATTERY)
J	1	WG140	4GA. 348" RED CABLE (CIRCUIT BREAKER TO 150AMP FUSE BOX)
K	1	WG143	8GA. 20" BLACK CABLE (SOLENOID TO PUMP GROUND)
L	1	WG127	4GA. 24" RED CABLE (CIRCUIT BREAKER TO WINCH SOLENOIDE)
M	1	WG125	4GA. 170 BLACK AND RED CABLE (SOLENOID TO WINCH)
N	1	WG110	4GA. 36" RED CABLE (150AMP FUSE BOX TO BATTERY)
O	1	WG132	14GA. 4" BLACK CABLE (SOLENOID TO SOLENOID GROUND)
P	1	WG144	4GA. 24" RED CABLE (CIRCUIT BREAKER 150AMP TO PUMP SOLENOID)

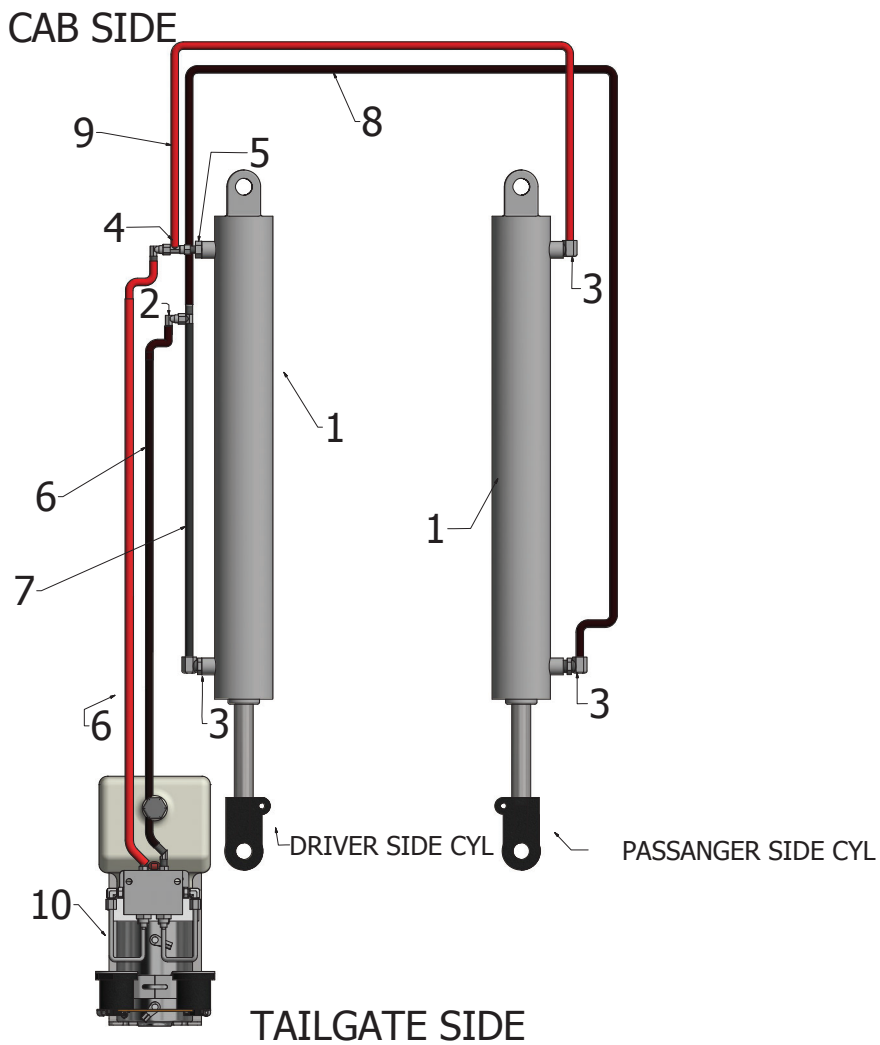

HYDRAULIC PART LIST			
ITEM	QTY	PART NUMBER	DESCRIPTION
1	2	IMP2014	CYLINDER
2	1	IMP523	HYD TEE
3	3	IMP1054	1/4 JIC-M X 1/2 MORB 90 ELBOW
4	1	IMP856	1/4 F.S X 1/4 MF X 1/4 MF
5	1	IMP1026	1/4 JIC-M X 1/2 MORB STRAIGHT
6	2	IMP1098	HYD HOSE 36"
7	1	IMP1096	HYD HOSE 28"
8	1	IMP1143	HYD HOSE 16'
9	1	IMP1144	HYD HOSE 14'
10	1	IMP2095	MONARCH PUMP

****NOTE #8,#9 HYD HOSE SIZES ARE FOR 8' BEDS****

IMPAC 2000 Installation Help Sheet

Place spreader bars with 4 (2 x 6 x 12 pieces of wood) in bed to square the unit.



When installing Power Cord drill hole before setting unit all the way to left side of bed. Run power line through hole and set unit with spreaders next to left bed wall.



When installing unit you may have to improvise when mounting support nuts and bolts through bed. If squared unit lines up on bed seam make sure to drill holes to outside of seam. You will sometimes have to use a cone drill bit at an angle (see Photos) to increase size of hole and then re-drill at an angle to be on the outside of the bed seam.



After unit is square secure with front and back nuts and bolts .

[illegible]

This image shows a single sheet of white paper with horizontal ruling lines. The lines are evenly spaced and run across the width of the page. There are no margins, text, or other markings on the paper.